

# 39F SEALED 39F-MC MAG-DRIVE



**3 - SERIES  
ROTOGEAR®  
GEAR PUMP**



Sealed

Close Coupled:  
Sealed or Mag-Drive

## PERFORMANCE CURVES

1 CPS Fluid (Water)

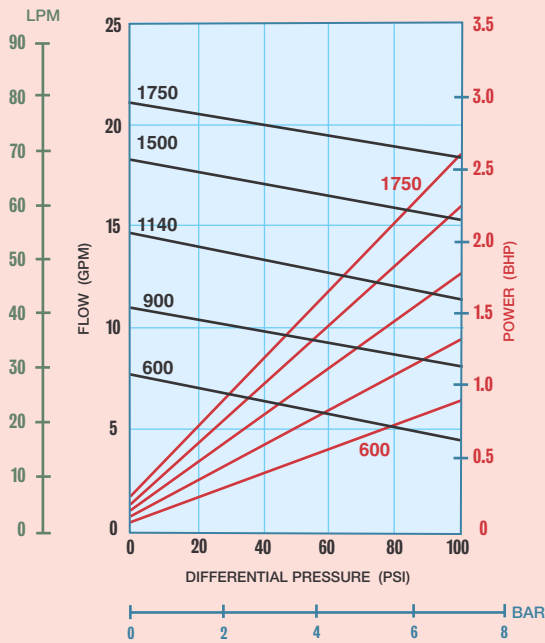

100 CPS Fluid (Oil)

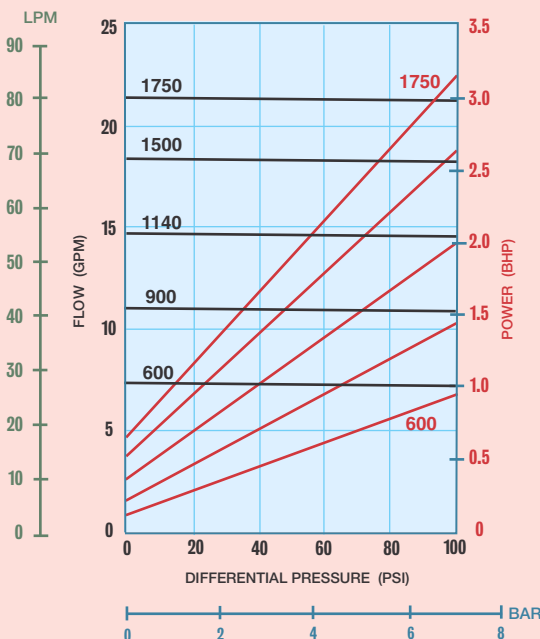

<b>PORT SIZE</b>	<b>1 1/4" NPT/BSPT/FLG</b>
<b>MAX FLOW</b>	<b>21.5 GPM; 81.4 LPM</b>
<b>MAX DIFFERENTIAL PRESSURE</b>	<b>100 PSI; 7 BAR</b>
<b>MAX DISCHARGE PRESSURE</b>	<b>225 PSI; 15.5 BAR</b>
<b>MAX TEMPERATURE</b>	<b>500°F; 260°C</b>
<b>MIN TEMPERATURE</b>	<b>-40°F; -40°C</b>
<b>MAX VISCOSITY</b>	<b>100,000* CPS</b>
<b>NPSHR @ 1750 RPM</b>	<b>3 FT; 0.96 M</b>
<b>LIFT (DRY)</b>	<b>14 FT; 4.2 M</b>
<b>WEIGHT (without motor)</b>	
<b>SEALED MAG-DRIVE</b>	<b>9.8 LBS; 4.4 KGS 40 LBS; 18 KGS</b>

\* Higher viscosities possible. Contact factory.

Dimensional Data (inches)

### Long-Coupled: 39F Sealed

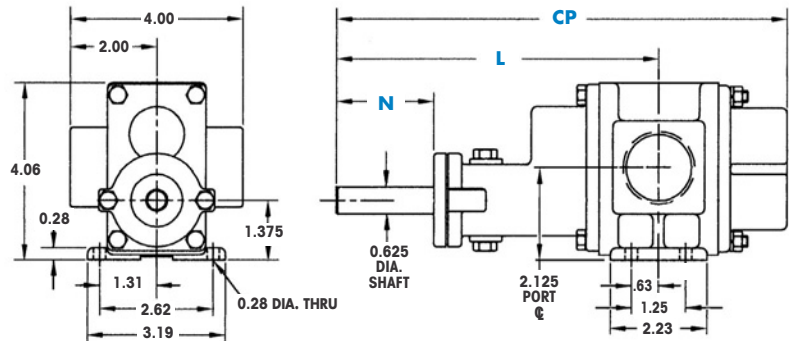

### SEAL CONFIGURATIONS

DIMENSION	SEAL CONFIGURATIONS		
	PACKING SINGLE MECHANICAL SEAL DOUBLE MECHANICAL SEAL	EXTERNAL MECHANICAL SEAL	LIP SEAL
CP <sup>(1)</sup>	10.44	10.44	10.44
N	1.68 <sup>(2)</sup>	1.06	1.68
L	7.47	7.47	7.47

NOTES: (1) Add .312 inches for Bearing Flush Plug.  
(2) Minimum dimension.

Dimensional Data (inches)

### Close-Coupled: 39F-MC & 39F Sealed

