

GD SERIES CAVITY STYLE TECHNOLOGY

Micropump's GD Series can be optimized by selecting an abrasion resistant cavity style pump chamber and hardened steel gears. As a result, GD Series pumps offer extended life in aggressive environments.

These magnetically driven gear pumps have provided solutions for customers applications for more than 60 years. Our cavity style gear pumps feature no dynamic seals for applications that cannot tolerate leaks.

MAGNETIC DRIVE GEAR PUMP

SMALL SIZE

The miniature package size of the GD Series is easily incorporated into the design of many systems.

HIGH-SYSTEM PRESSURE CAPABILITY

GD Series can offer an optional high-powered, high system pressure version for pressures up to 103 bar (1500 psi).

REVERSE PUMPING CAPABILITY

Micropump cavity style gear pumps can be designed for applications with the need for intermittent reverse pumping.

LEAK FREE

Micropump's design utilizes static seals for leak free, contamination free operation.

NEMA 56C MOUNT

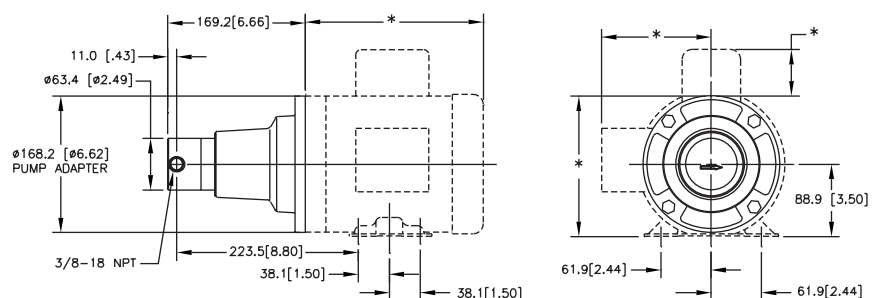

IEC 71-B14-MOUNT

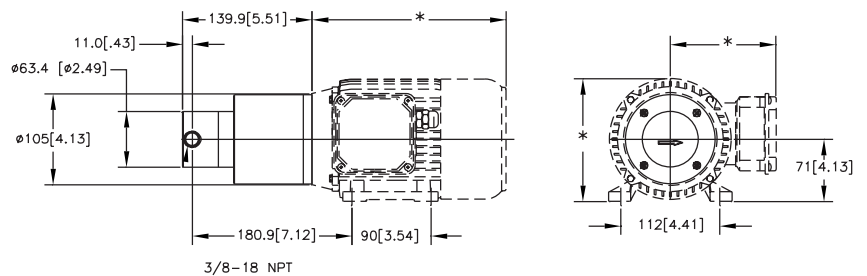

PUMP FLOW RANGE

(Based on Constant Speed Curves)

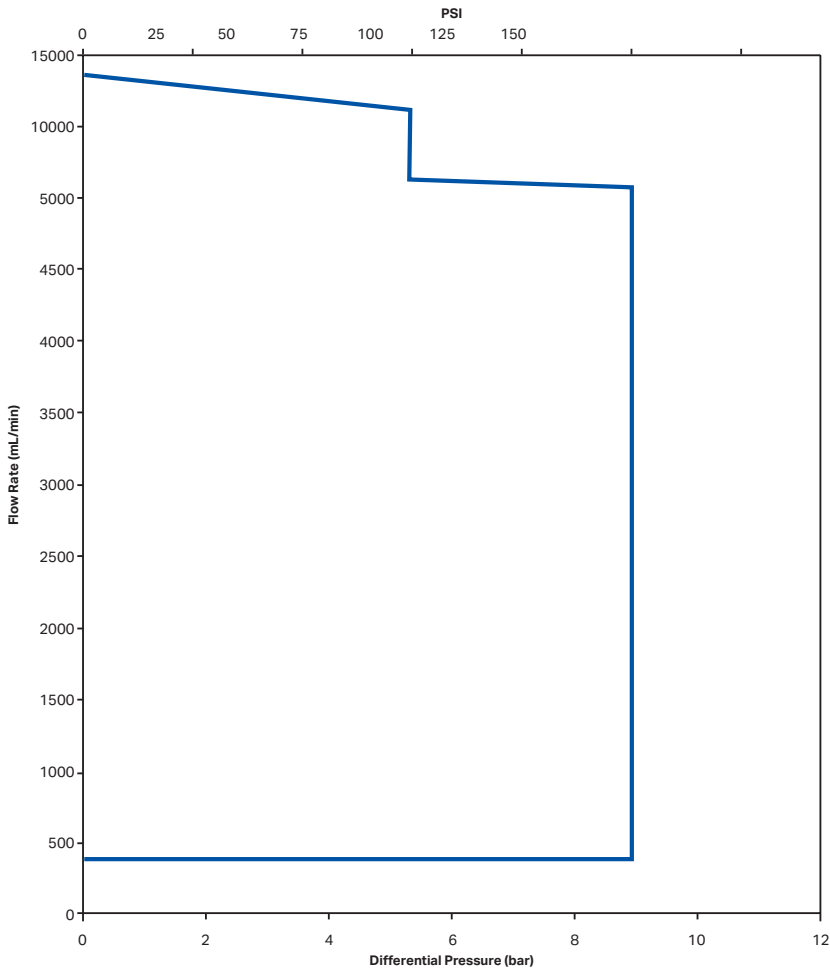

MAGNETIC GEAR PUMP FEATURES

CAVITY STYLE PUMPS

Cavity style pumps are excellent for wide-ranging inlet and outlet operating conditions. The helical gears allow for a highly quiet and efficient pump for fluid movement.

SMOOTH PULSELESS DELIVERY

Positive displacement, precision gears provide consistent fluid delivery in continuous processes.

EASY TO SERVICE

Series GA/GAH pumps are easy to service using a Micropump® service kit and simple hand tools.

FLUID PATH INTEGRITY

The magnetic drive and static o-ring seal(s) keep the fluid securely inside the pump and potential contaminants out.

CHEMICALLY RESISTANT

Chemically inert materials for harsh environments.

PERFORMANCE SUMMARY

FLOW RATE AT 4000 RPM

- 13.9 L/min (3.7 US gpm)

DISPLACEMENT

- Gear Set M35
- mL/rev 3.48
- US gal/1000 rev 0.92

MAXIMUM RATED DIFFERENTIAL PRESSURE

- 6.9 Bar (100 psi)

MAXIMUM RATED SYSTEM PRESSURE

- 103 Bar (1500 psi)

TEMPERATURE RANGE

- 46 to 204 °C (-50 to 400 °F)

VISCOSITY RANGE

- 0.5 to 1500 cps

MAXIMUM SPEED

- 4000 rpm

PUMP CONSTRUCTION

- Magnetic drive gear pump
- Cavity style
- Three helical gears
- Stationary shafts
- O-ring seal

WETTED MATERIALS

BASE MATERIAL

- 316 stainless steel
- Titanium*
- Alloy 20*
- Hastalloy C-276*

GEARS

- PEEK
- PPS
- Hardened steel*

STATIC SEALS

- Viton
- Kalrez
- EP
- TEV

MAGNETS

DRIVEN AND DRIVING

- Ferrite
- Rare earth*

*Denotes customization or materials that may require minimum order quantities.

ACTUAL PERFORMANCE MAY VARY. Specifications are subject to change without notice.



OFFICIAL UK DISTRIBUTOR: Michael Smith Engineers Limited

Web: www.michael-smith-engineers.co.uk | Email: info@michael-smith-engineers.co.uk | Freephone: 0800 316 7891

©Micropump, Inc. | A unit of IDEX